



How to collect cheek swabs

To get your cheek swab kit, visit the Genomia laboratory website and make an on-line order or contact us by e-mail or phone. You can use your own sterile brush as well. In case of on-line orders, our system automatically generates the identification number of the tested animal.

Cheek swab samples can be collected either by breeders themselves or by vets. In case you decide to ask a vet he/she can verify the identity of the tested animal.

Every Genomia cheek swab kit contains:

- 2x sterile cytobrushes (two brushes per animal)
- yellow envelope where to put the collected sample
- order form
- address label
- as a return envelope, you can use the envelope in which you received the collection kit

Recommendation:

Avoid the contamination of samples! Collect a sample of one animal at a time. In case it is necessary to collect multiple samples, please, complete the procedure one by one.

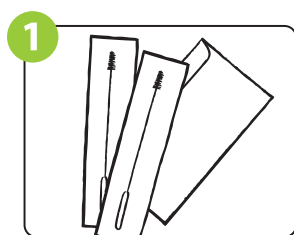

Please, mark the the yellow long paper envelope and with identification data about the animal (name of the animal, microchip number, sample number if assigned...).

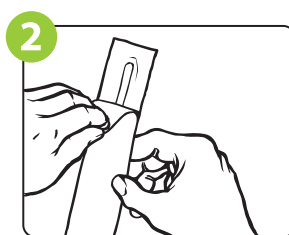

Before you collect a swab, make sure the oral cavity of the animal is clean. The animal should not eat or drink at least 15 minutes before the sample collection.

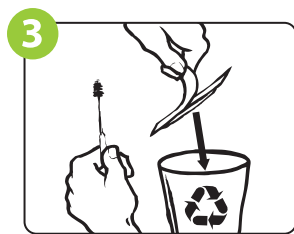

Remove the sterile brush. Do not touch the bristle tip! The brush must be kept intact – it must not get in touch with anything, except the cheek tissue of the tested animal.

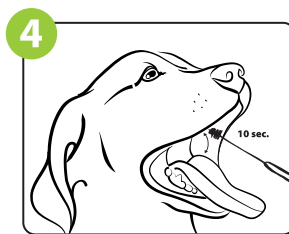

Insert the brush into one side of the mouth between the inside of the cheek and the upper gum. Press firmly and twirl the brush against the inside of the inner cheek about 10 times to collect cells. Avoid tongue and try not to collect too much saliva.

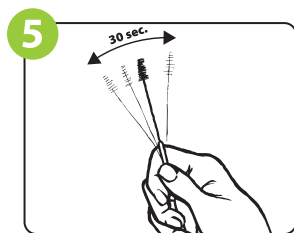

Air-dry the brush for several minutes. Hold the brush in your hand all the time – it is necessary to avoid any possible contamination. In case you put a wet brush into the paper envelope it can lead to the degradation due to a possible bacterial growth.

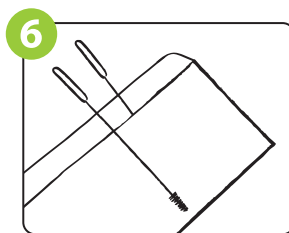

Put the dry brush directly to the marked long envelope.

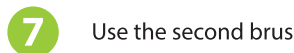

Use the second brush and repeat the steps 3-6 then add the second brush to the same envelope and seal it.

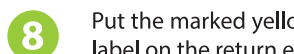

Put the marked yellow envelope with the brushes into a return envelope. Enclose also the completed order form. Stick an address label on the return envelope. Send the shipment to the address: **Genomia, Republikánská 6, 312 00 Plzeň, Czech Republic**

How to collect the cheek swaps from animals which are still nursed!

Keep a few steps to avoid any contamination with the mother's cells. Mutual licking of young animals can also compromise testing. Please, keep in mind that animals which are still nursed should not be in contact with their mother and/or other siblings minimum 30 minutes before collecting the swab.